

DORNIER Do X LANDING GEAR INSTALLATION

1. Locate the template that was supplied with your Dornier Do X.

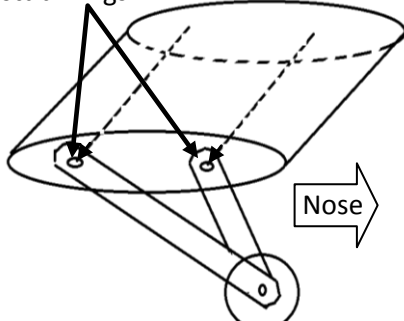

2. Use this template to drill through the outer surfaces of the lower stub wings.



3. Test-fit the strut attachment bolts, landing gear struts and nuts.

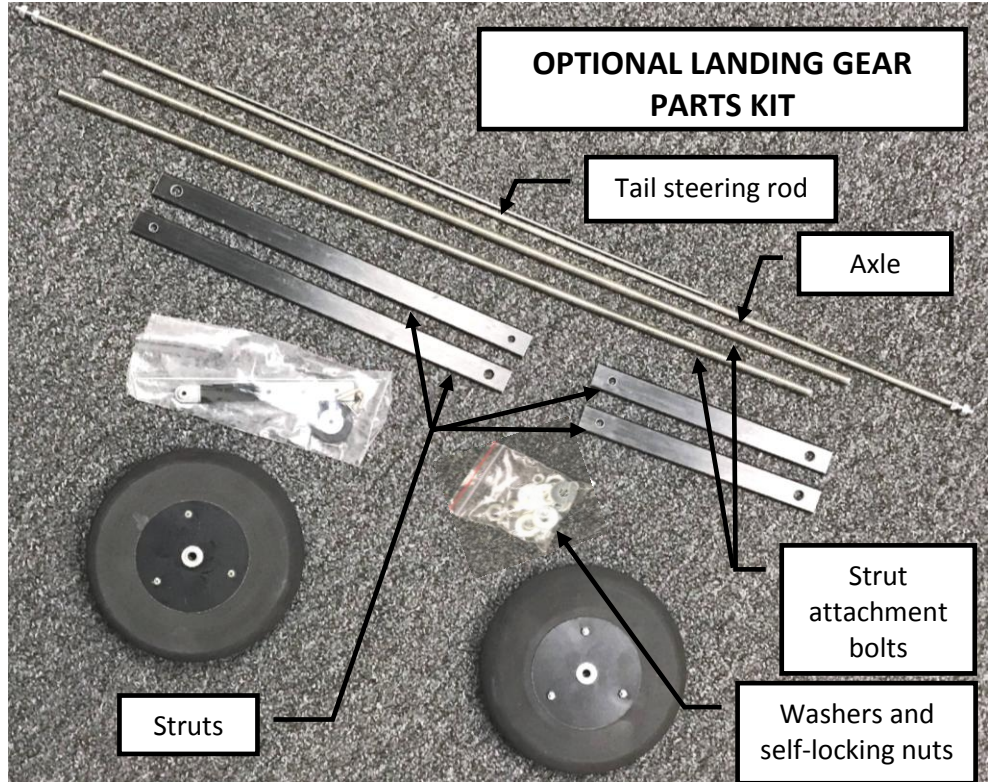
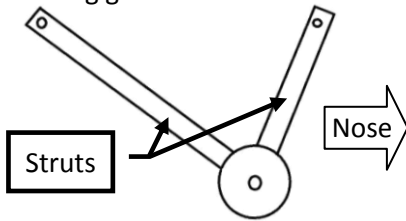

4. Insert and center the axle through the struts, then install the wheels and nuts.

5. As pictured at the right and below, test-fit the tail wheel strut assembly to the bottom of the fuselage. Position the tail wheel pivot below the rudder's hinge line.

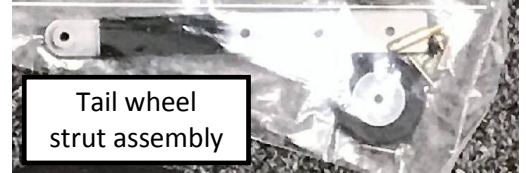

6. Use wood screws to attach the tail-wheel strut to the fuselage.

7. As shown at the right and below, bend the tail steering rod to fit between the rudder and the tail wheel's steering arm.

